

- FIREBAG® is a DIN 3586 DVGW certified passive safety device manufactured by TECO since 1995.
- It blocks the gas flow automatically when the ambient temperature reaches 212 °F (in the event of fire).
- When in the tripped position under thermal stress (high-

temperature resistance: see table for values), maintains a gas tight closure, stopping gas flow, and preventing gas from fueling the fire.

- Does not require maintenance.

Material	
Body	Cartridge
Zinc plated Steel	Thermo sensitive alloy

### TECHNICAL SPECIFICATIONS

Reference standards	Maximum Allowable Operating Pressure (MAOP)	Operating Temperature	Set-off Temperature	High temperature resistance (Fire Resistance)	Application
DIN 3586 <sup>(1)</sup> Gas directive EU/2016/426	150 psig	-40 °F - 176 °F <sup>(2)</sup> [-40 °C - 80 °C]	203 °F - 212 °F (95 °C - 100 °C)	Pressure up to 150 psig Temperature up to 1500 °F Guaranteed resist for 90' Max. Leakage <sup>(3)</sup> : 3.18 ft³/h The FireBag exceeds the DIN3586 High Temperature Requirements: 1200°F for 30 minutes at 72.5 psig	Natural gas, butane, propane

#### NOTE

- A standard coat of primer and paint is permitted on the body of the device. Avoid excessive paint thickness, avoid painting the heat sensor (for devices 1" - 1 1/4" - 1 1/2" - 2"), avoid using insulation of any kind which could impair the functioning of the device.

(1) The devices covered by this specification fully comply with the high temperature resistance requirements of DIN 3586. Compliance with declared performances has been tested in the laboratory.  
 (2) The device temperature shall never exceed the declared value. Be aware that radiant heat combined with high temperature may lead the device to be exposed to excessive heat.  
 (3) Average flow value over 90 min. (Test method according to DIN 3586).

### FUNCTION AND INTEGRATED TECHNOLOGIES

FIREBAG® is composed of an external steel body and a thermal sensitive device.

When the external temperature reaches 203 °F - 212 °F, the metal alloy that holds the plug to the cartridge melts, and the compression force of the spring pushes the plug against the gas flow orifice, closing it.

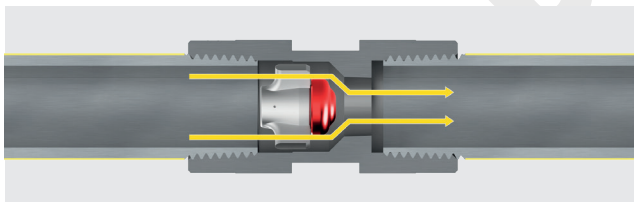

Inactive T < 194 °F

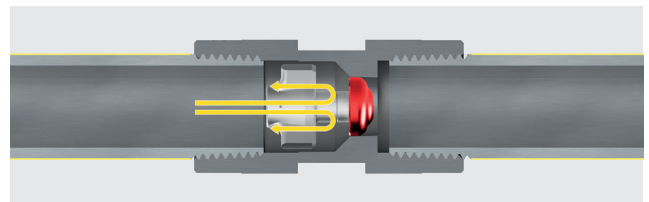

Thermally activated T > 212 °F

### TEMPERATURE SENSOR FOR 1" TO 2" DEVICES

The temperature sensor may have different shapes depending on the model and version of the device.

In this document, a neutral graphic representation A has been chosen to show the true appearance B or C, depending on the version and model.

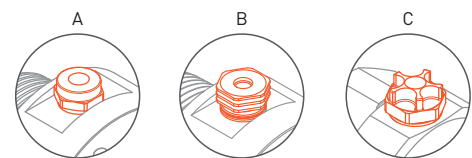

## MODELS, FLOW DIRECTION, AND DIMENSIONS

**FIREBAG** fitting threaded NPT – (inlet FEMALE connection / outlet MALE connection)

3/4"

1"

1 1/4" - 1 1/2" - 2"

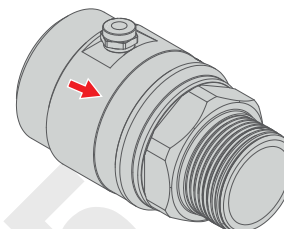
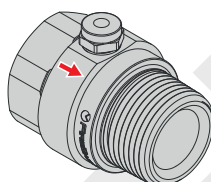
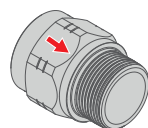
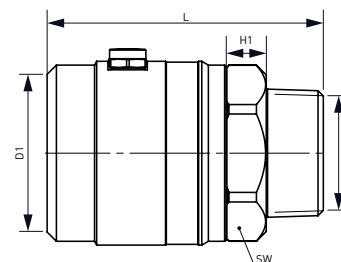
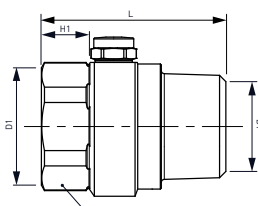
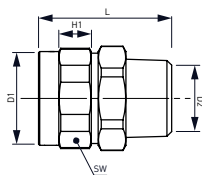

Part Number	Size D1	L ±0.08 (in)	H1 (in)	SW (in)	KV	CV
FBAS20001	3/4" - 14 NPT	1.93	0.80	1 1/4"	5.7	6.7
FBAS25001	1" - 11.5 NPT	2.26	0.59	1 1/2"	8.9	10.4
FBAS32003 <sup>(2)</sup>	1 1/4" - 11.5 NPT	3.62	0.59	2"	22	25.7
FBAS40003 <sup>(2)</sup>	1 1/2" - 11.5 NPT	3.67	0.59	2 1/3"	32	42.7
FBAS50003 <sup>(2)</sup>	2" - 11.5 NPT	4.72	0.71	2 3/4"	54	66.7

<sup>(2)</sup> Upon receipt of a Purchase Order, dimensions will be verified. Verified dimensions may be +/- 2% of listed values.

**FIREBAG** fitting threaded NPT – (inlet FEMALE connection / outlet FEMALE connection)

1/2" - 3/4"

1"

1 1/4" - 1 1/2" - 2"

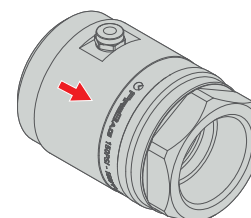
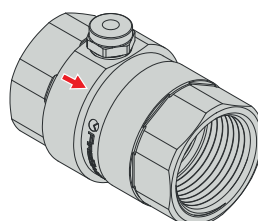
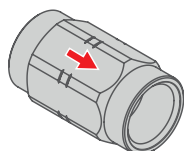
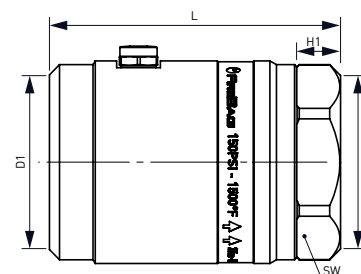
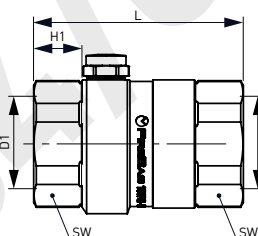
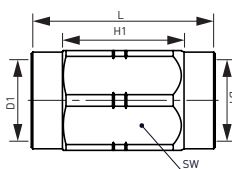

Part Number	Size D1	L ±0.08 (in)	H1 (in)	SW (in)	KV	CV
FBAS15004	1/2" - 14 NPT	2.21	1.52	1"	3.2	3.7
FBAS20003	3/4" - 14 NPT	2.32	1.53	1 1/4"	5.7	6.7
FBAS25003	1" - 11.5 NPT	2.60	1.41	1 1/2"	8.9	10.4
FBAS32004 <sup>(2)</sup>	1 1/4" - 11.5 NPT	3.74	0.55	2"	22	25.7
FBAS40004 <sup>(2)</sup>	1 1/2" - 11.5 NPT	3.94	0.59	2 1/3"	32	42.7
FBAS50004 <sup>(2)</sup>	2" - 11.5 NPT	4.37	0.71	2 3/4"	54	66.7

<sup>(2)</sup> Upon receipt of a Purchase Order, dimensions will be verified. Verified dimensions may be +/- 2% of listed values.

## MODELS, FLOW DIRECTION, AND DIMENSIONS

● **FREBAG** fitting threaded NPT – (inlet MALE connection / outlet FEMALE connection)

1/2" - 3/4"

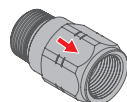
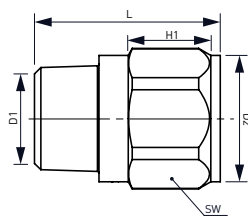

1"

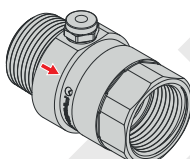
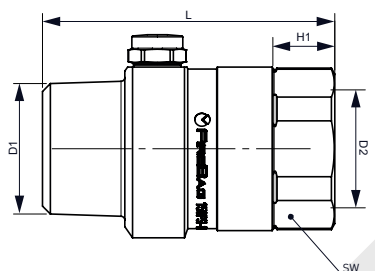

1 1/4" - 1 1/2" - 2"

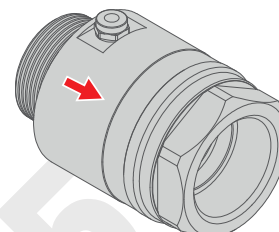
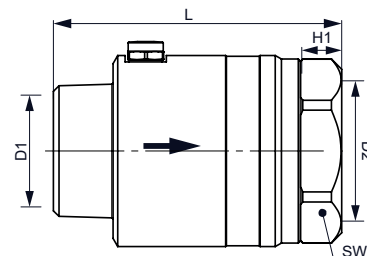

Part Number	Size D1	Size D2	L ±0.08 (in)	H1 (in)	SW (in)	KV	CV
FBAS15003	1/2" - 14 NPT	3/4" - 14 NPT	2.87	1.14	1 1/4"	7.6	8.9
FBAS20002	3/4" - 14 NPT	3/4" - 14 NPT	2.30	1.12	1 1/4"	5.8	6.8
FBAS25002	1" - 11.5 NPT	1" - 11.5 NPT	2.85	1.04	1 1/2"	9.0	10.5
FBAS32001 <sup>(2)</sup>	1 1/4" - 11.5 NPT	1 1/4" - 11.5 NPT	3.94	0.55	2"	22	25.7
FBAS40001 <sup>(2)</sup>	1 1/2" - 11.5 NPT	1 1/2" - 11.5 NPT	4.13	0.59	2 1/3"	32	42.7
FBAS50001 <sup>(2)</sup>	2" - 11.5 NPT	2" - 11.5 NPT	4.37	0.71	2 3/4"	54	66.7

<sup>(2)</sup> Upon receipt of a Purchase Order, dimensions will be verified. Verified dimensions may be +/- 2% of listed values.

● **FREBAG** fitting threaded NPT – (inlet MALE connection / outlet MALE connection)

3/4"

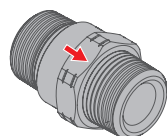
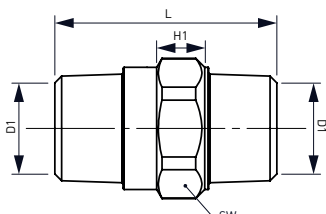

1"

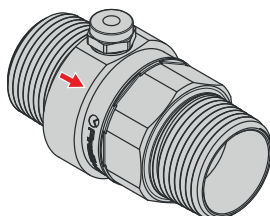
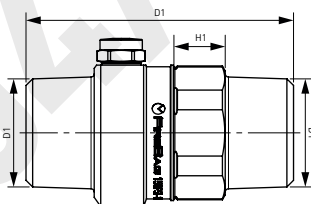

1 1/4" - 1 1/2" - 2"

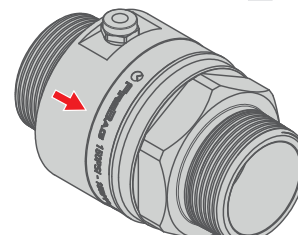
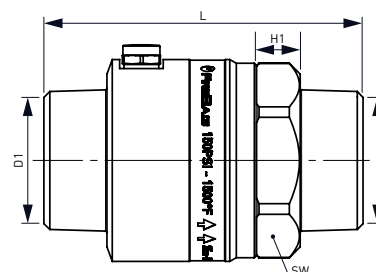

Part Number	Size D1	L ±0.08 (in)	H1 (in)	SW (in)	KV	CV
FBAS20004	3/4" - 14 NPT	2.09	0.39	1 1/4"	5.6	6.6
FBAS25004	1" - 11.5 NPT	3.15	0.39	1 1/2"	8.8	10.2
FBAS32002 <sup>(2)</sup>	1 1/4" - 11.5 NPT	4.13	0.55	2"	22	25.7
FBAS40002 <sup>(2)</sup>	1 1/2" - 11.5 NPT	4.33	0.59	2 1/3"	32	42.7
FBAS50002 <sup>(2)</sup>	2" - 11.5 NPT	4.72	0.71	2 3/4"	54	66.7

<sup>(2)</sup> Upon receipt of a Purchase Order, dimensions will be verified. Verified dimensions may be +/- 2% of listed values.

## KITS (FIREBAG® & COMPANION FITTING)

FIREBAG fitting threaded NPT – (inlet MALE connection / outlet FEMALE connection)

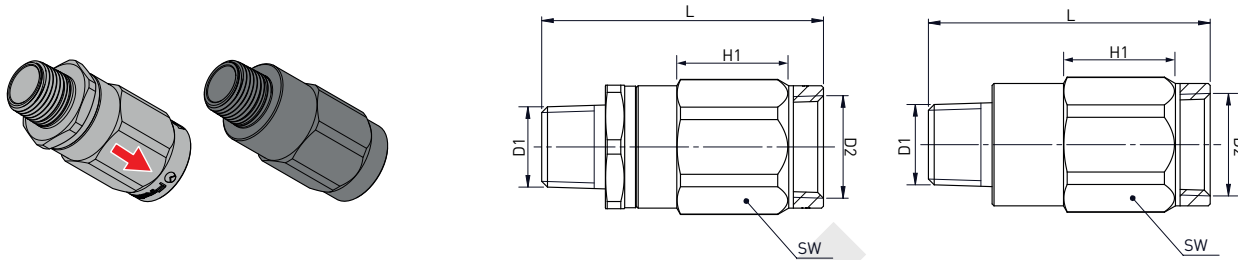

Part Number	Size D1	Size D2	L ±0.08 (in)	H1 (in)	SW (in)	KV	CV
OEAS0001	1/2" - 14 NPT	3/4" - 14 NPT	2.87	1.14	1 1/4"	7.6	8.9

Data is based on the FIREBAG® fitting (FBAS15003) included in the kit.

FIREBAG fitting threaded NPT – (inlet MALE connection / outlet FEMALE connection)

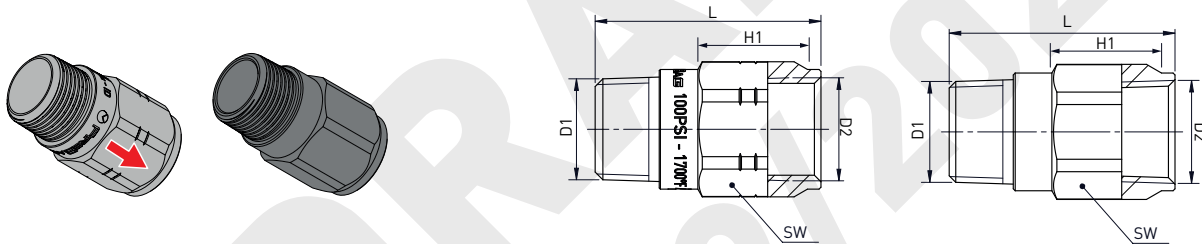

Part Number	Size D1/D2	L ±0.08 (in)	H1 (in)	SW (in)	KV	CV
OEAS0002	3/4" 14 NPT	2.30	1.12	1 1/4"	5.8	6.8

Data is based on the FIREBAG® fitting (FBAS20002) included in the kit.

FIREBAG fitting threaded NPT – (inlet MALE connection / outlet FEMALE connection)

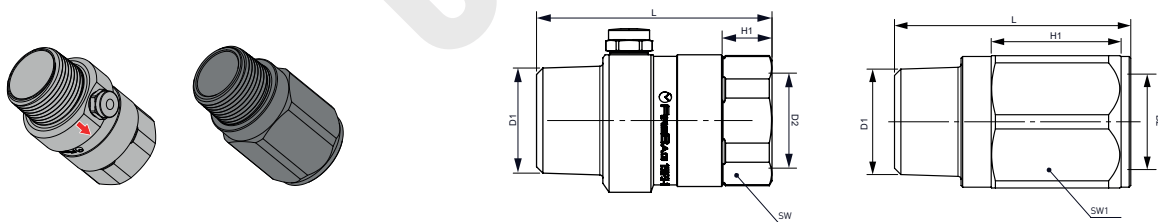

Part Number	Size D1/D2	L ±0.08 (in)	H1 (in)	SW (in)	SW1 (in)	KV	CV
OEAS0006	1" 11.5 NPT	2.85	1.04	1 1/2"	1 2/3"	9.0	10.5

Data is based on the FIREBAG® fitting (FBAS25002) included in the kit.

# PRESSURE DROP GRAPH

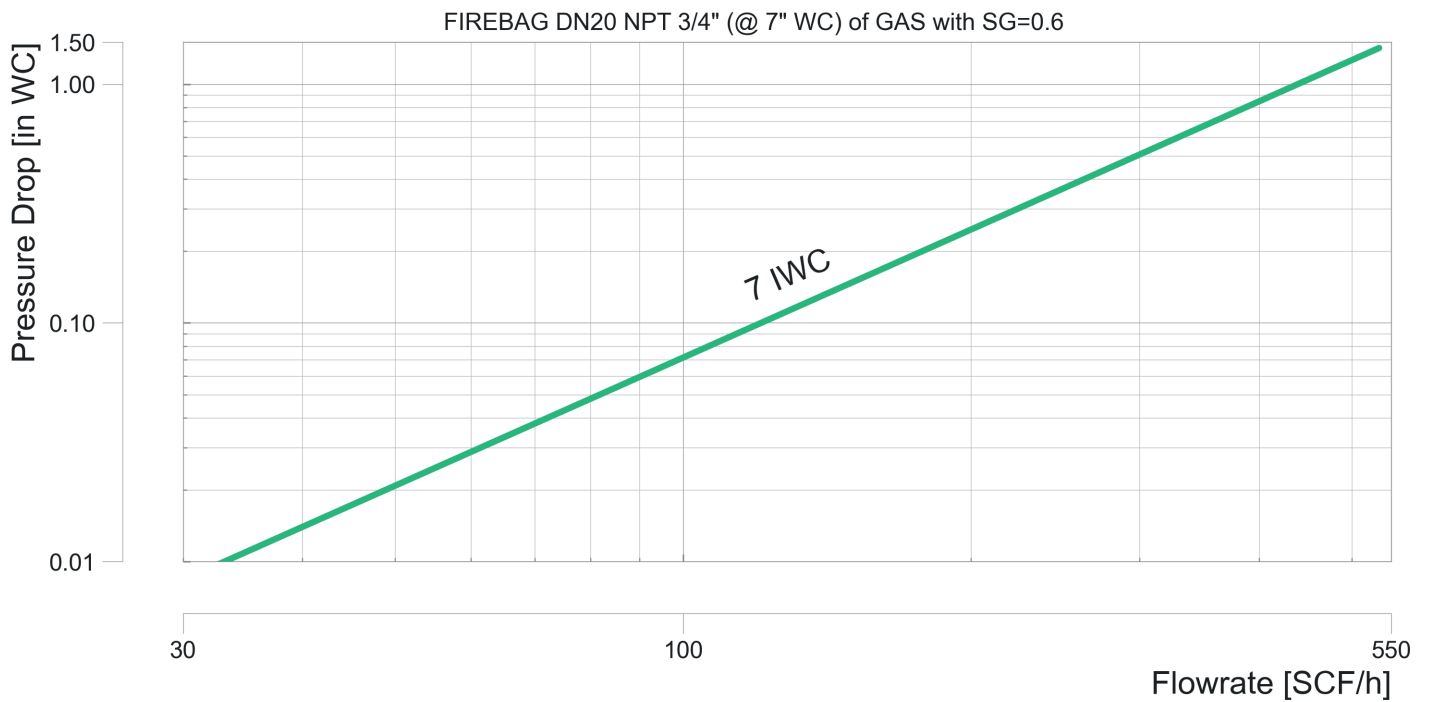
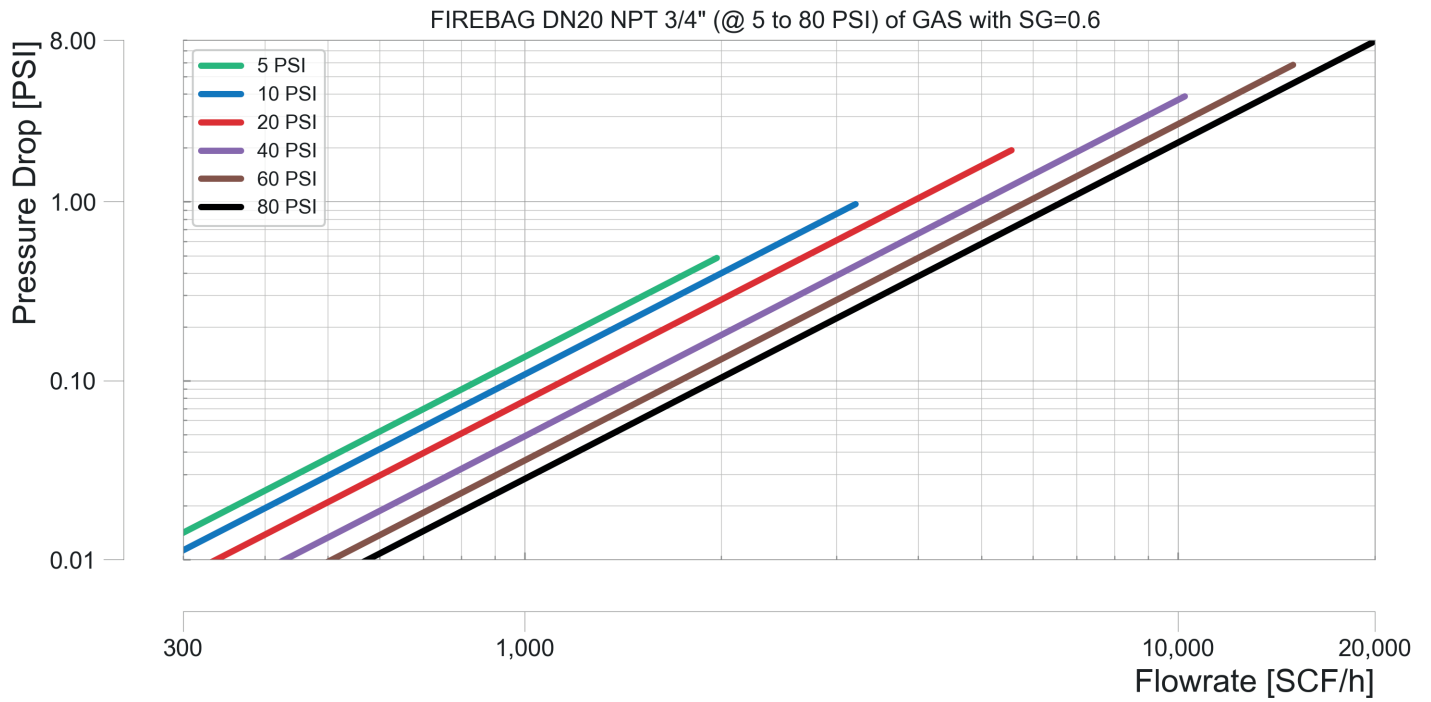

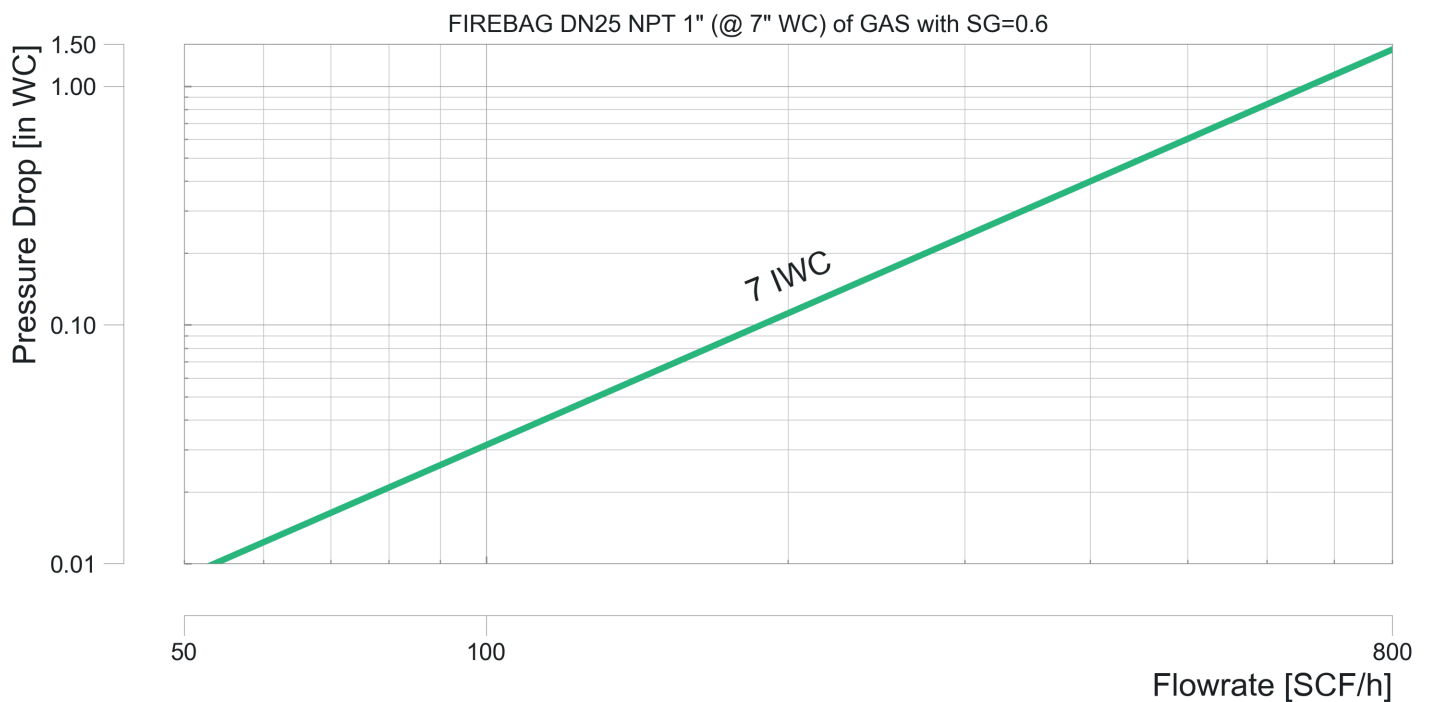
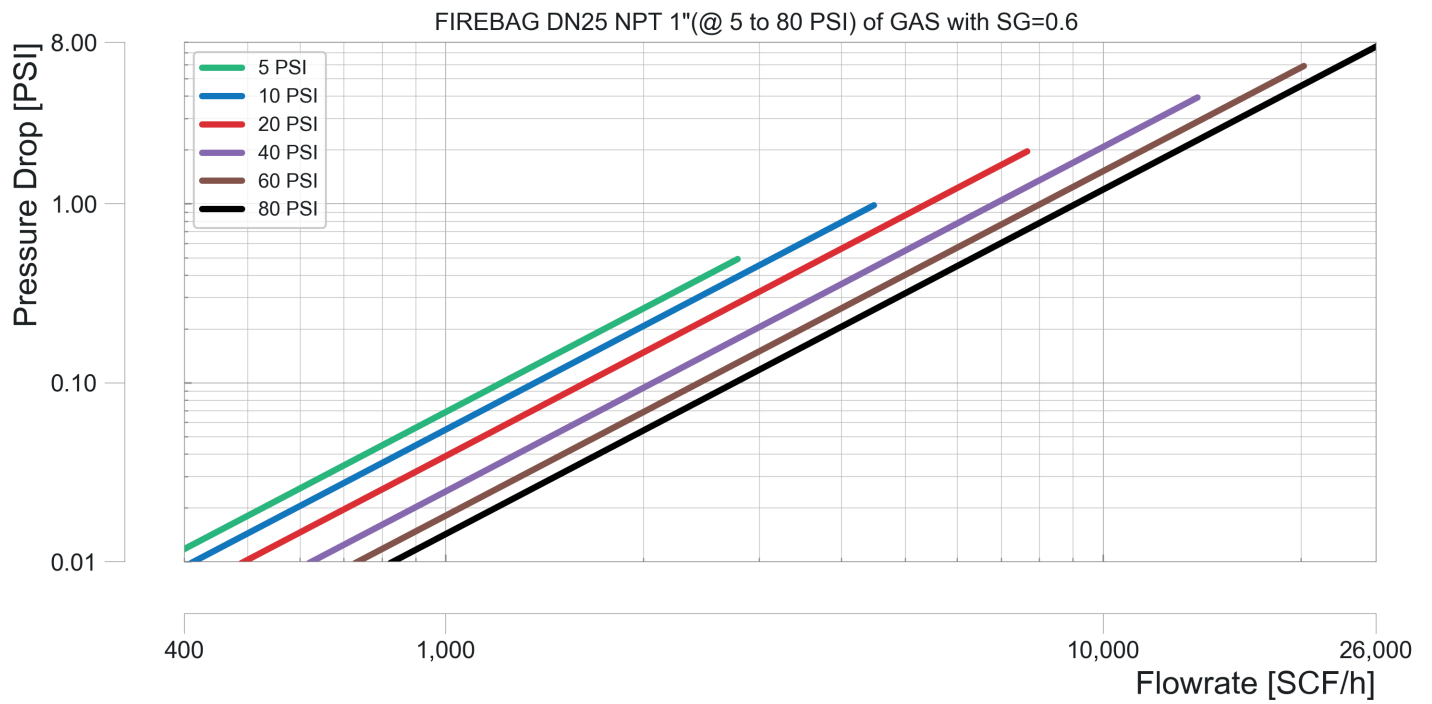

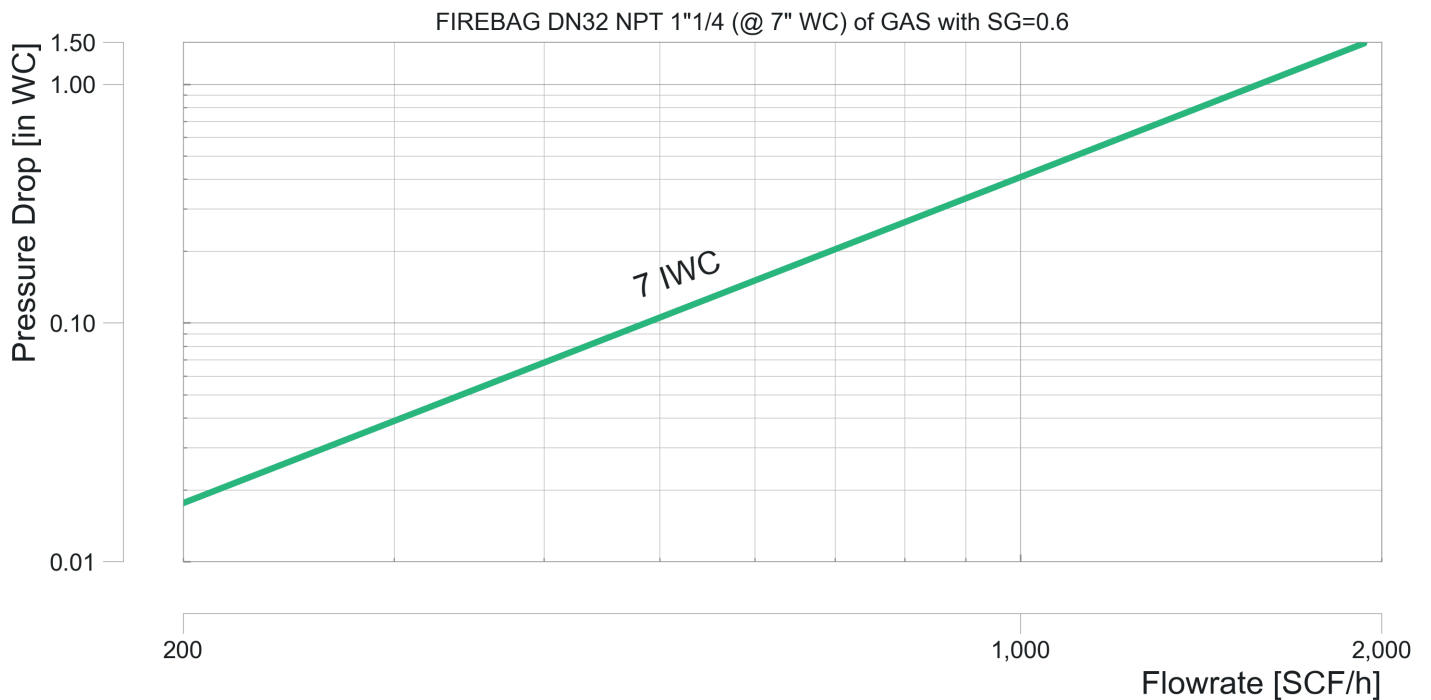
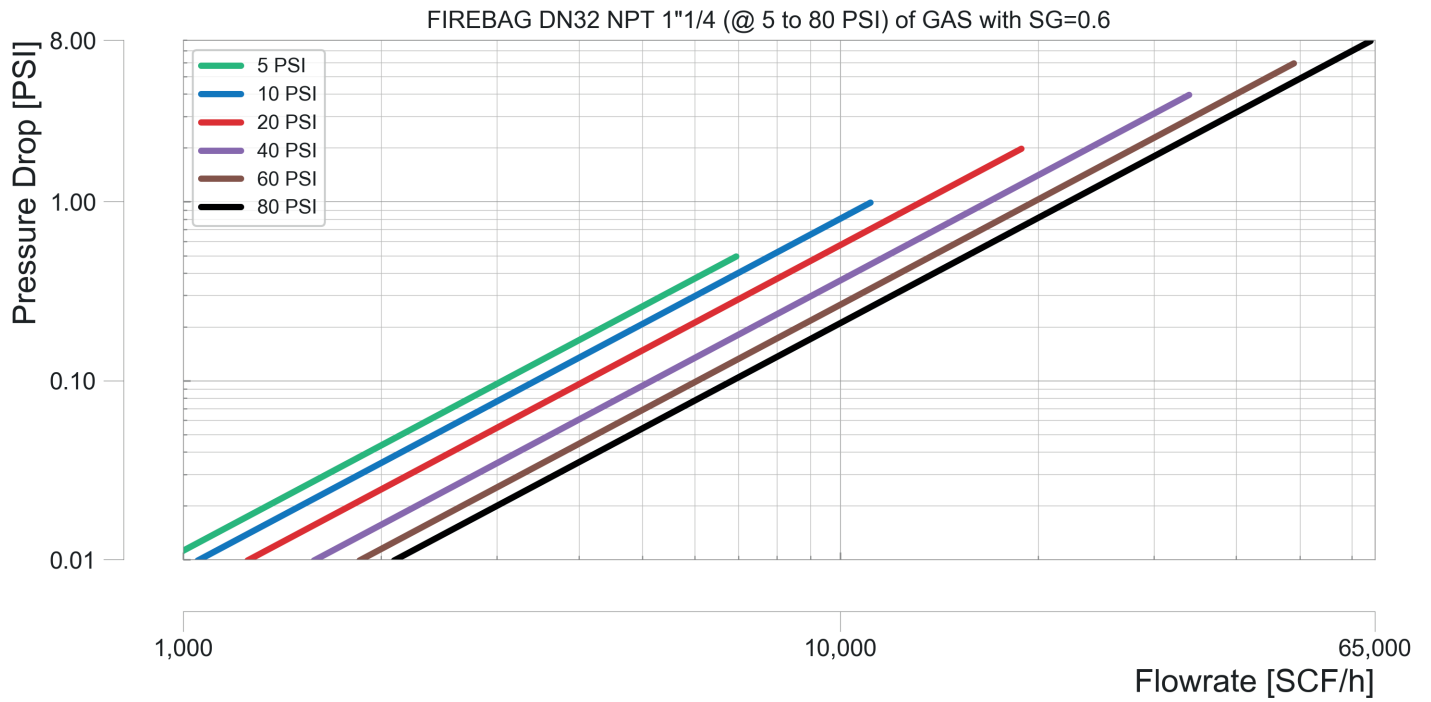

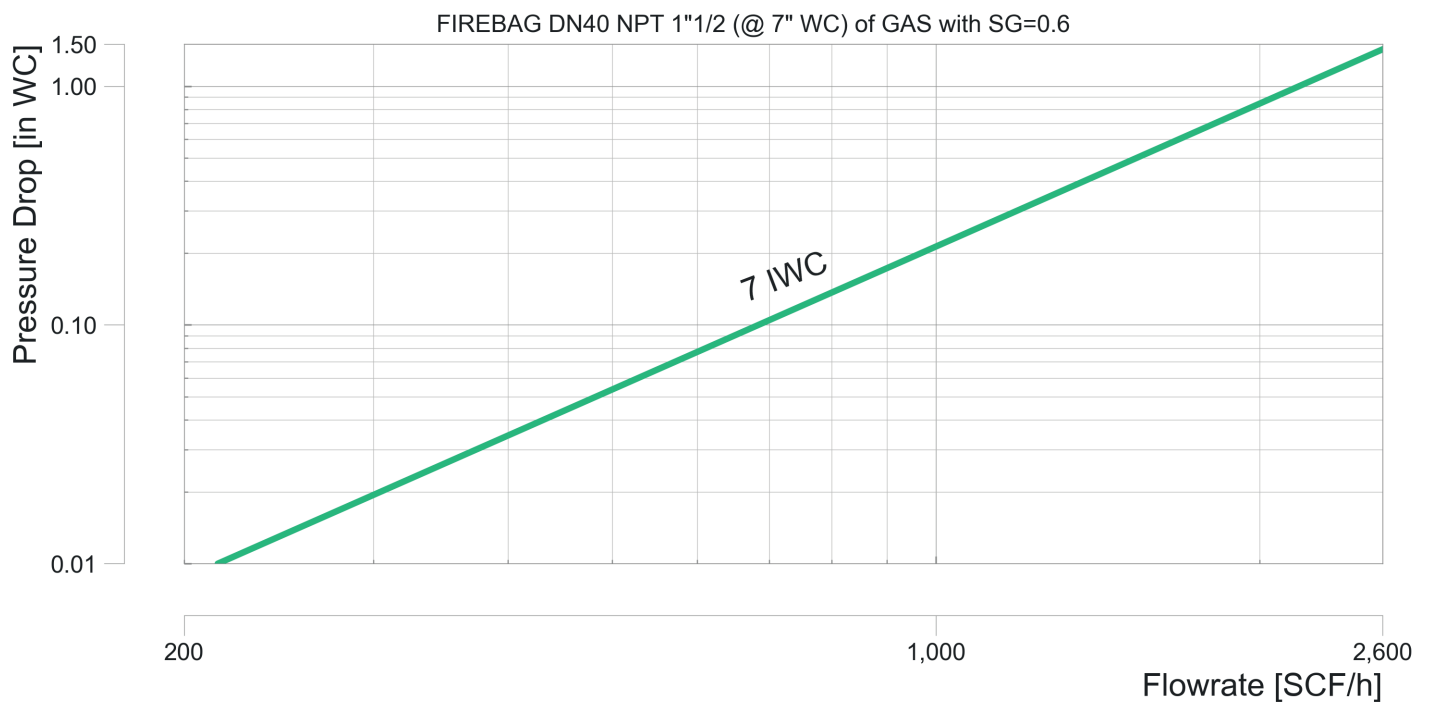
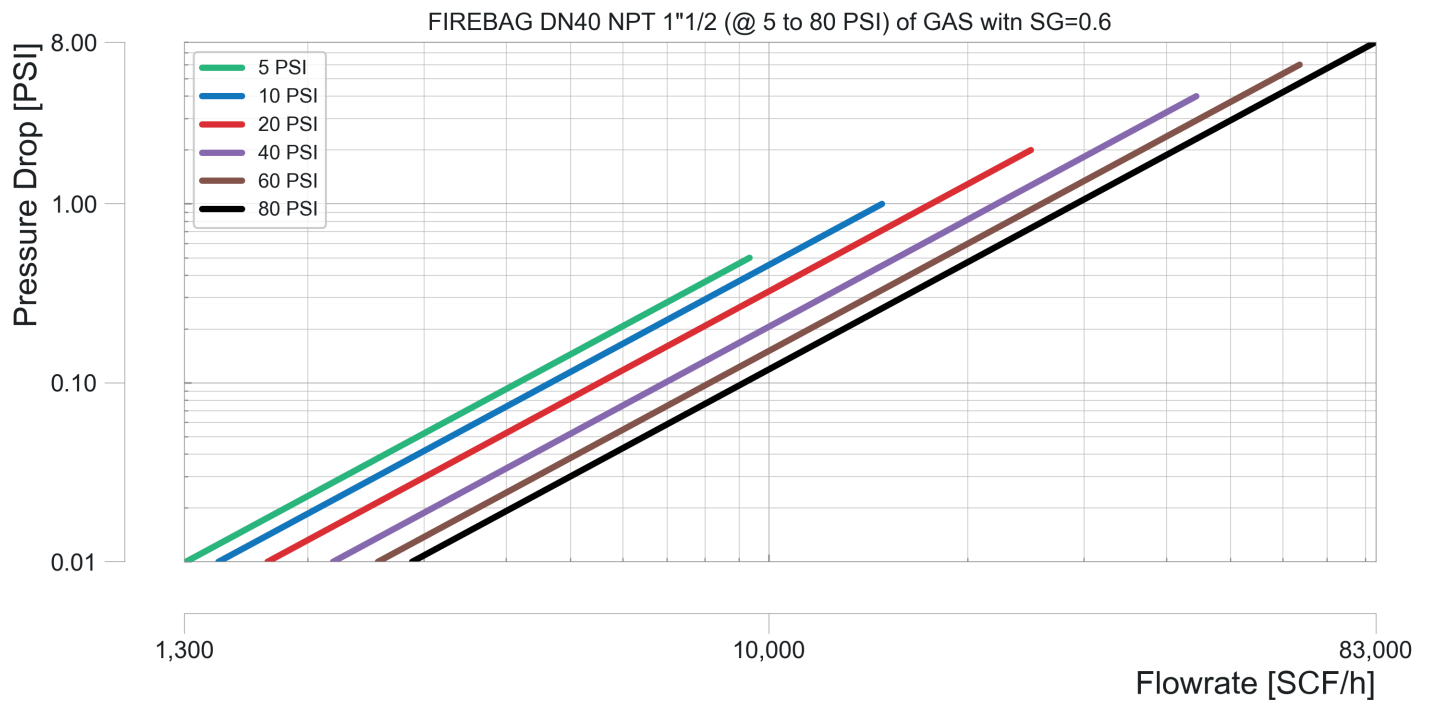



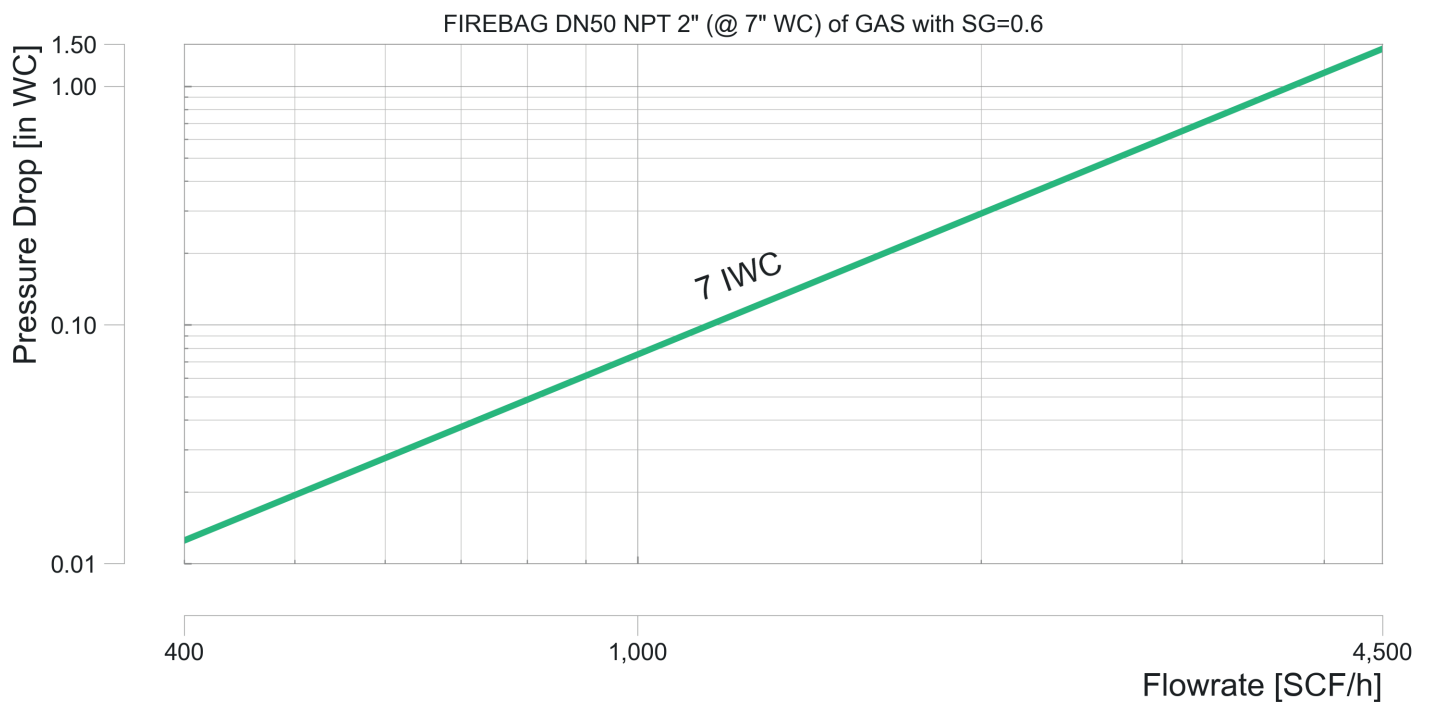
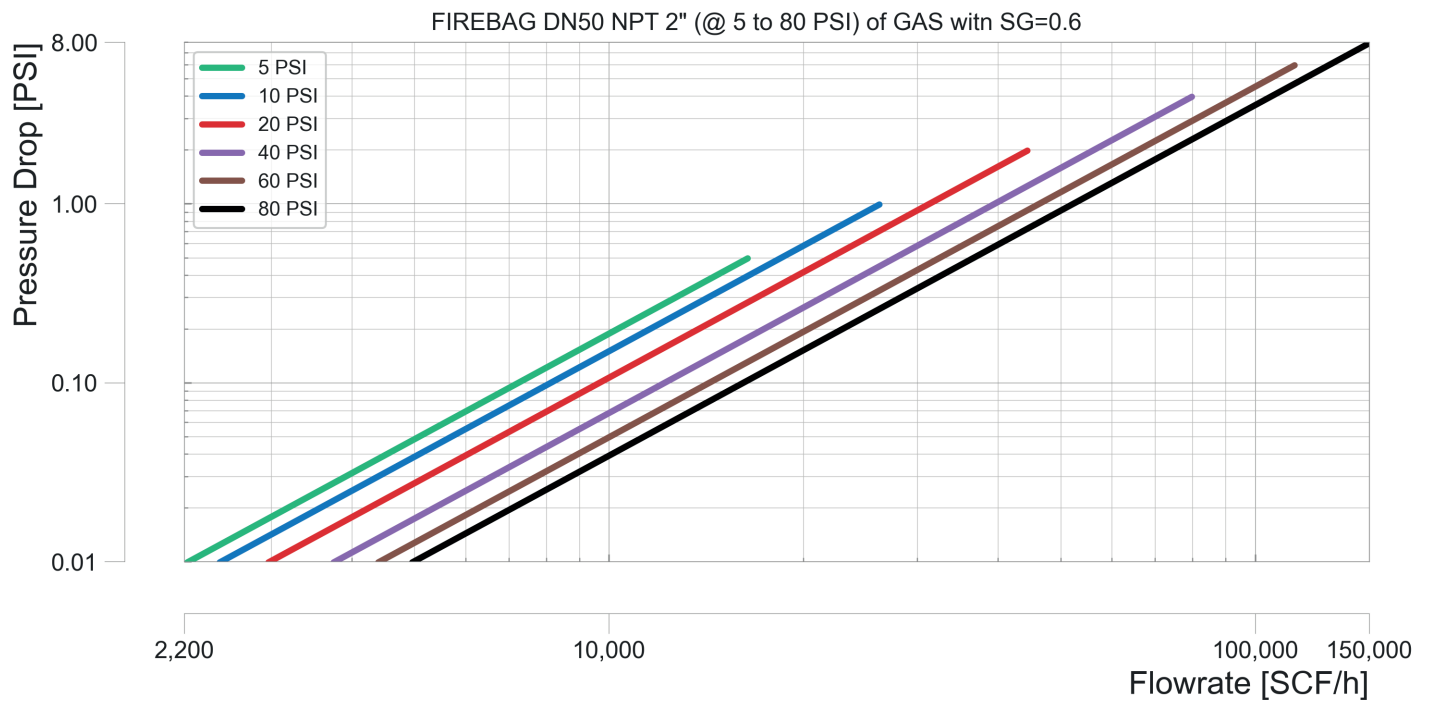

TECO® Americas, LLC  
263 Cox Street  
Roselle, NJ 07203

+1 908-488-0909  
inquiry@tecoamericas.com | tecoamericas.com



**TECO® AMERICAS**  
INNOVATING GAS SAFETY